

SONOFF

BASICZBR3

User manual V1.2

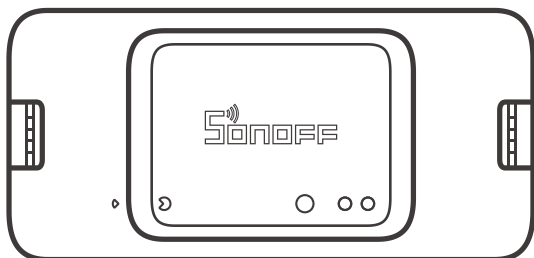

ZigBee DIY Smart Switch

· 中文-----	1-5	· English-----	6-10
· Deutsch-----	11-16	· Español-----	17-22
· Français-----	23-28	· Italiano-----	29-34
· Русский язык-----	35-40	· Português-----	41-46

· FCC Warning-----	47		

本设备需连接SONOFF ZigBee网关进行智能操作。

⚠ 设备支持其他无线协议为ZigBee 3.0的网关, 具体以实际产品为准。

使用说明

1. 断电

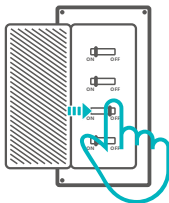

⚠ 设备安装、故障维修请由专业资质电工操作, 以免发生触电危险! 设备在正常使用的情况下不可触碰到。

2. 接线

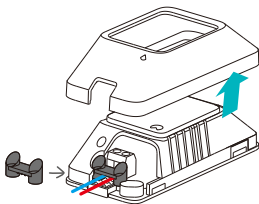

拆下保护盖, 先接线再安装压线柱。

⚠ 安装保护盖时确保保护盖上的标识 ◀ 和设备上的标识 ▶ 对齐, 否则无法合上。

吸顶灯接线示意:

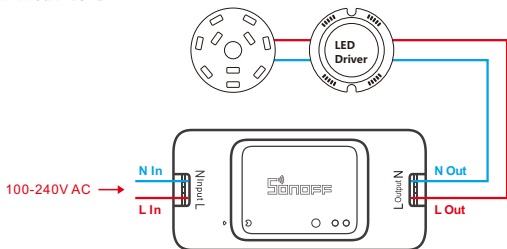

单火线输出接线示意:

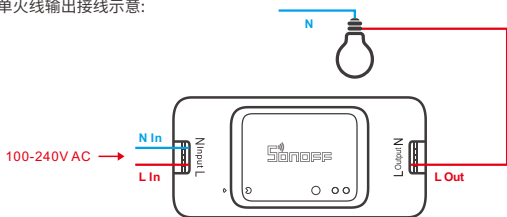

⚠ 确保零火线接入无误。

3. 下载“易微联”APP

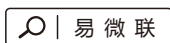

Android™ & iOS

4. 上电

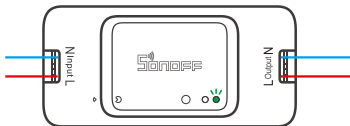

通电后，设备首次使用，默认进入配对状态，ZigBee 信号指示灯呈“闪烁”状态。

⚠ 如长时间未进行下一步操作，设备可能退出配对模式，如需再次进入，长按配对按钮5秒直到ZigBee信号指示灯“闪烁”即可。

5. 添加子设备

⚠ 添加子设备前, 请先连接SONOFF网关。

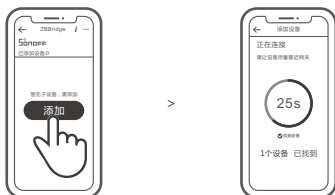

打开eWeLink APP, 选择需要连接的网关, 点击"添加"子设备, 等待搜索添加设备。

⚠ 如添加失败, 请将设备移近网关后再重新添加。

SONOFF ZigBee网关支持同时连接多个子设备

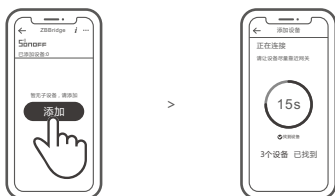

先将网关通电, 设置让所需配对的子设备进入配对状态, 然后打开eWeLink APP网关页面, 点击"添加", 等待搜索添加设备。

更多APP应用平台及网关推荐



SmartThings



Amazon Alexa

本设备除支持SONOFF ZigBee网关外,还支持以下网关:

Echo Studio
Echo Plus (型号: ZE39KL)
2nd Gen Echo Show (型号: DW84JL)
2nd Gen Echo Plus (型号: L9D29R)
Samsung SmartThings hub

添加说明:

1. 参照网关使用说明书下载相应APP和连接网关。
2. 将设备设置到配对模式。
3. 根据网关对应的APP提示添加设备,添加过程中选择 eWeLink 或 SONOFF 品牌。

⚠ 如添加失败,请将设备移近网关后再重新添加。

产品参数

型号	BASICZBR3
输入	100-240V AC 50/60Hz 10A Max
输出	100-240V AC 50/60Hz 10A Max
ZigBee	IEEE 802.15.4
支持平台	Android & iOS
工作温度	-10°C~40°C
材料	PC V0
产品规格	91x43x25mm

产品介绍

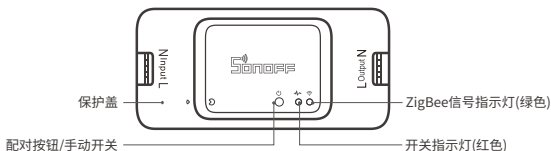

ⓘ 设备重量 < 1Kg, 建议安装高度 < 2米。

产品特点

SONOFF智能开关 (ZigBee版) 基于ZigBee无线通讯协议, 通过连接ZigBee网关实现远程控制、设置定时开/关、设备智能场景联动等功能。



远程控制



智能定时/延时



语音控制



智能场景控制



分享功能

ⓘ 以上功能特点取决于ZigBee网关的功能。

更换设备网络

设备更换新的网络环境使用时, 需长按设备配对按钮5秒直到 ZigBee指示灯呈闪烁状态, 松开, 此时设备进入快速配网模式, 即可再次添加。

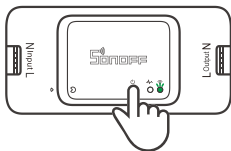

恢复出厂设置

在eWeLink app端“删除设备”，设备即恢复出厂设置。

The device can be operated intelligently via working with the SONOFF ZigBee Bridge.

⚠ The device can work with other gateways supporting ZigBee 3.0 wireless protocol. Detailed information is in accordance with the final product.

Operating Instruction

1. Power off

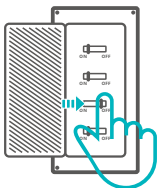

⚠ To avoid electric shocks, please consult the dealer or a qualified professional for help when installing and repairing! Please do not touch the switch during use.

2. Wiring instruction

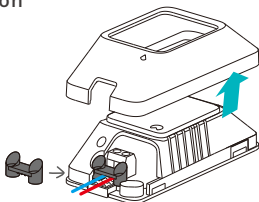

Remove the Protective cover, then connect wires before fixing the wire fastener.

⚠ To make sure a full installation, please align "◆" with "●" when securing the protective cover.

Ceiling lamp wiring instruction:

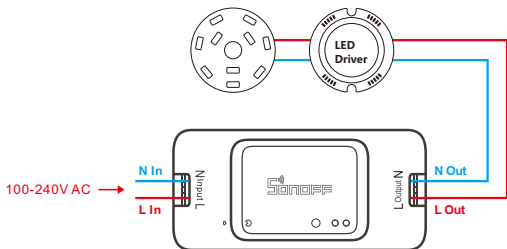

One live wire wiring instruction:

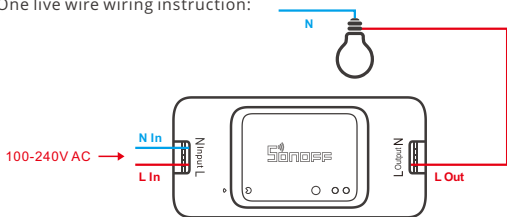

⚠ Make sure the neutral wire and live wire connection is correct.

3. Download APP

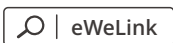

Android™ & iOS

4. Power on

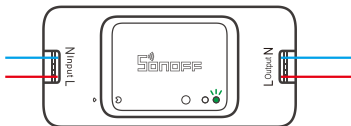

After powering on, the device will enter the pairing mode during the first use and the ZigBee LED signal indicator flashes.

⚠ The device will exit the pairing mode if no next operation for a long time. If enter again, please long press the pairing button for 5s until the ZigBee LED signal indicator flashes and release.

5. Add sub-devices

⚠️ Connect the SONOFF ZBBridge before adding the sub-device.

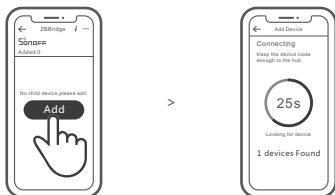

Access eWeLink APP, select the Bridge that you want to connect, and tap "Add" to add a sub-device, and be patient until pairing completes.

⚠️ If the addition failed, move the sub-device closer to the Bridge and try again.

SONOFF ZigBee Bridge supports connecting multiple sub-devices at the same time.

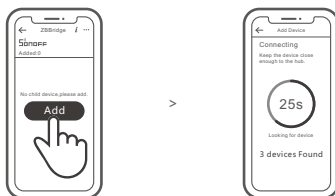

Power the Bridge on, set the sub-device to the pairing mode. Then access the Bridge page in the eWeLink APP to tap "Add", and be patient until the pairing completes.

More APP application platforms and gateway recommendations



SmartThings



Amazon Alexa

This device supports the following gateways besides SONOFF ZigBee :

Echo Studio
Echo Plus (model: ZE39KL)
2nd Gen Echo Show (model: DW84JL)
2nd Gen Echo Plus (model: L9D29R)
Samsung SmartThings hub

Gateway adding instruction:

1. Refer to the gateway user manual to download the matched APP and get it paired.
2. Set ZBMINI to the pairing mode.
3. Add ZBMINI according to the prompt of APP. You should select eWeLink or SONOFF when adding.

⚠ If the addition failed, move the sub-device closer to the Bridge and try again.

Specifications

Model	BASICZBR3
Input	100-240V AC 50/60Hz 10A Max
Output	100-240V AC 50/60Hz 10A Max
ZigBee	IEEE 802.15.4
Operating systems	Android & iOS
Working temperature	-10°C~40°C
Material	PC V0
Dimension	91x43x25mm

Product Introduction

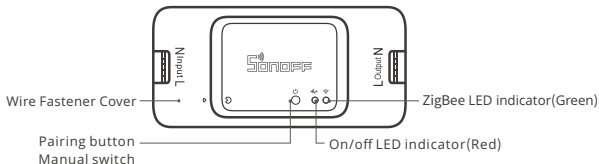

- ⚠ The device weight is less than 1 kg.
The installation height of less than 2 m is recommended.

Features

SONOFF ZigBee smart devices based on ZigBee wireless communication protocol allow you to remotely turn on/off, schedule on/off connected devices, and set smart scenes, etc.



Remote Control



Single/Countdown
Timing



Voice Control



Smart Scene



Share Control

- ⚠ Above functions are determined by ZigBee Hub.

Switch Network

If you need to change the network, long press the pairing button for 5s until the ZigBee LED signal indicator flashes and release. then the device enters quick pairing mode and you can pair again.

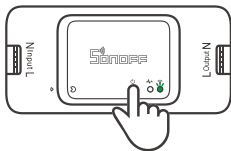

Factory Reset

Deleting the device on the eWeLink app indicates you restore it to factory setting.

Das Gerät kann intelligent betrieben werden, indem man mit dem SONOFF ZigBee Gateway arbeitet.

⚠ Das Gerät kann mit anderen Gateways zusammenarbeiten, die das drahtlose ZigBee 3.0-Protokoll unterstützen. Detaillierte Informationen sind in Übereinstimmung mit dem Endprodukt.

Betriebsanweisung

1. Ausschalten

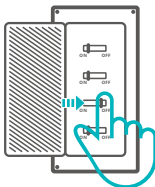

⚠ Wenden Sie sich bitte an den Händler oder einen qualifizierten Fachmann, um Hilfe bei der Installation und Reparatur zu erhalten und um Stromschläge zu vermeiden! Bitte berühren Sie den Schalter nicht während des Betriebs nicht.

2. Verkabelungsanleitung

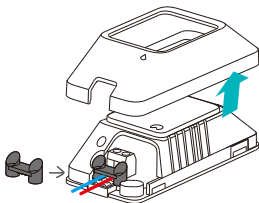

Entfernen Sie die Schutzabdeckung und schließen Sie dann die Kabel an, bevor Sie das Kabelbefestigungselement befestigen.

⚠ Damit die Installation korrekt fertiggestellt werden kann, richten Sie beim Befestigen der Schutzabdeckung bitte "◆" mit "●" aus.

Verkabelungsanleitung für Deckenleuchten:

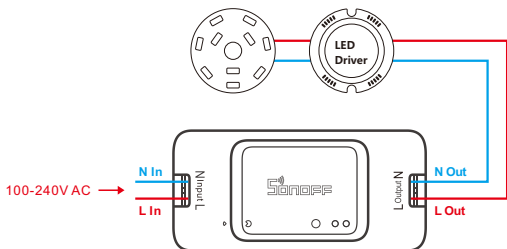

Verkabelung mit einer stromführenden:

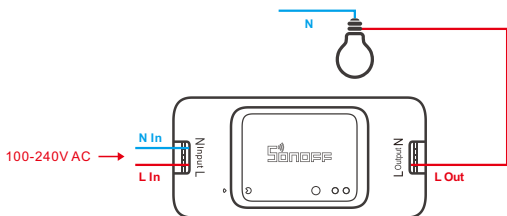

- ⓘ Vergewissern Sie sich, dass der Anschluss von Neutralleiter und stromführender Phase korrekt sind.

3. APP herunterladen

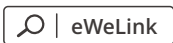

Android™ & iOS

4. Einschalten

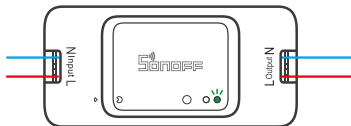

Nach dem Einschalten schaltet sich das Gerät während des ersten Gebrauchs in den Kopplungsmodus und die ZigBee LED-Signalanzeige blinkt.

- ⚠ Das Gerät verlässt den Kopplungsmodus, wenn über einen längeren Zeitraum keine weitere Bedienung erfolgt. Bei erneuter Eingabe drücken Sie bitte den Handschalter 5 Sekunden lang gedrückt, bis die ZigBee LED-Signalanzeige blinkt und dann loslassen.

5. Untergeräte hinzufügen

- ⚠ Schließen Sie das Gateway an, bevor Sie das Untergerät hinzufügen.

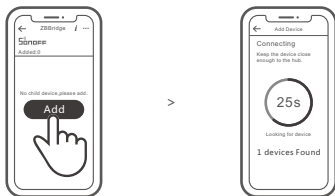

Rufen Sie eWeLink APP auf, wählen Sie das Gateway, das Sie verbinden möchten, und tippen Sie auf „Hinzufügen“, um ein Untergerät hinzuzufügen, und haben Sie Geduld, bis die Kopplung abgeschlossen ist.

- ⚠ Wenn das Hinzufügen fehlgeschlagen ist, bewegen Sie das Untergerät näher an das Gateway und versuchen Sie es erneut.

SONOFF das ZigBee-Gateway unterstützt die gleichzeitige Verbindung mehrerer Untergeräte.

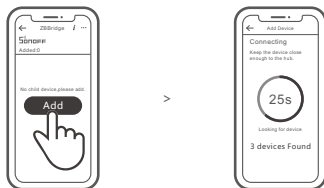

Schalten Sie die Gateway ein, stellen Sie das Untergerät in den Kopplungsmodus. Rufen Sie dann die Seite Gateway in der eWeLink APP auf, um auf „Hinzufügen“ zu tippen, und warten Sie, bis die Kopplung abgeschlossen ist.

Mehr APP-Anwendungsplattformen und Gateway-Empfehlungen



SmartThings



Amazon Alexa

Dieses Gerät unterstützt neben SONOFF ZigBee die folgenden Gateways:

Echo Studio
Echo Plus (Modell: ZE39KL)
2nd Gen Echo Show (Modell: DW84JL)
2nd Gen Echo Plus (Modell: L9D29R)
Samsung SmartThings hub

Anweisung zum Hinzufügen von Gateway:

1. Lesen Sie im Gateway-Benutzerhandbuch nach, um das passende APP herunterzuladen und es zu koppeln.
2. Stellen Sie ZBMINI in den Kopplungsmodus ein.
3. Fügen Sie ZBMINI entsprechend der Aufforderung der APP hinzu. Beim Hinzufügen sollten Sie eWeLink oder SONOFF wählen.

⚠ If the addition failed, move the sub-device closer to the Bridge and try again.

Technische Daten

Modell	BASICZBR3
Eingang	100-240V AC 50/60Hz 10A Max
Ausgang	100-240V AC 50/60Hz 10A Max
ZigBee	IEEE 802.15.4
Betriebssysteme	Android & iOS
Arbeitstemperatur	-10°C~40°C
Materialien	PC V0
Abmessungen	91x43x25mm

Produktvorstellung

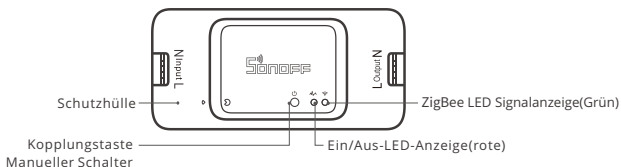

- ⓘ Das Gerätegewicht beträgt weniger als 1 kg.
Es wird eine Installationshöhe von weniger als 2 m empfohlen.

Merkmale

SONOFF ZigBee smartes Gerät, welches auf dem ZigBee drahtlosen Kommunikationsprotokoll aufbaut, ermöglicht Ihnen das ferngesteuerte Ein-/Ausschalten, die Planung des Ein-/Ausschaltens verbundener Geräte und die Einstellung intelligenter Szenen usw.



App
Fernbedienung



Einzel-/
Countdown-Timer



Sprachsteuerung



Intelligente
Szenarien



Freigabesteuerung

- ⓘ Alle Funktionen werden durch den ZigBee Hub bestimmt.

Schalt-Netzwerk

Wenn Sie das Netzwerk wechseln müssen, drücken Sie die Paarungstaste 5s lang, bis die ZigBee LED-Signalanzeige blinkt und dann loslassen. wechselt und das Gerät in den Schnellkopplungsmodus wechselt, Sie können dann erneut paaren.

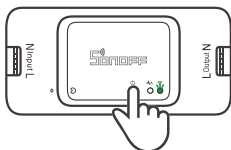

Zurücksetzen auf Werkseinstellungen

Wenn Sie das Gerät in der eWeLink-App löschen, wird es auf die Werkseinstellung zurückgesetzt.

El dispositivo puede operarse de forma inteligente trabajando con el SONOFF de ZigBee puerta de enlace.

- ⚠ El dispositivo puede trabajar con otras puertas de enlace que sean compatibles con el protocolo inalámbrico de ZigBee 3.0. La información detallada es conforme al producto final.

Instrucciones de funcionamiento

1. Apagado

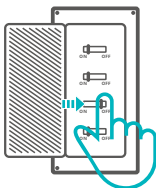

- ⚠ Para evitar descargas eléctricas, consulte con su distribuidor o un profesional cualificado para solicitar ayuda durante la instalación y la reparación!
No toque el interruptor durante el uso.

2. Instrucciones de cableado

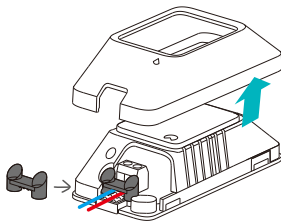

Quite la tapa de protección y, a continuación, conecte los cables antes de fijar el sujetacables.

- ⚠ Para asegurar la instalación completa, alinee "◆" con "●" al sujetar la tapa de protección.

Instrucciones de cableado de lámpara de techo :

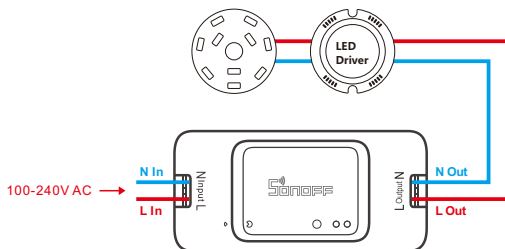

Instrucciones de cableado con un solo cable activo:

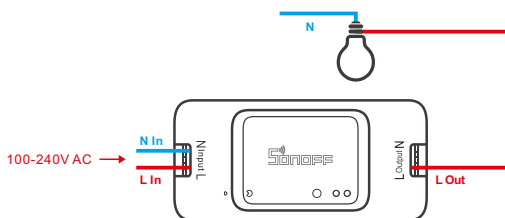

⚠ Compruebe que las conexiones del cable neutro y activo sean correctas.

3. Descargar la aplicación

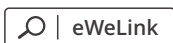

Android™ & iOS

4. Encender



Después de encender el dispositivo, este se pondrá en modo de emparejamiento durante el primer uso y el indicador de señal LED de ZigBee emitirá parpadeos.

⚠ El dispositivo saldrá del modo de emparejamiento si no entra en funcionamiento por durante un largo periodo. Si vuelve a ingresar, mantenga presionado el interruptor manual durante 5 segundos hasta que el indicador de señal LED de ZigBee parpadee y suelte el botón.

5. Agregar subdispositivos

⚠ Conecte la puerta de enlace antes de agregar el subdispositivo.

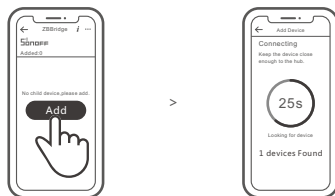

Acceda a la aplicación eWeLink, seleccione la puerta de enlace que desee conectar y toque en "Agregar" para agregar el subdispositivo, y tenga paciencia hasta que se complete el emparejamiento.

⚠ Si se produce un error al agregar, mueva el subdispositivo más cerca de la puerta de enlace e inténtelo de nuevo.

El SONOFF del puerta de enlace de ZigBee es compatible con la conexión de múltiples subdispositivos al mismo tiempo.

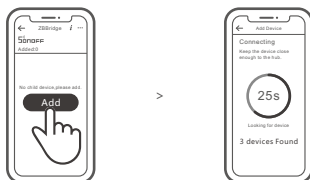

Encienda el Puente, configure el dispositivo subordinado en el modo de emparejamiento. Luego acceda a la página Puente en la aplicación eWeLink para tocar "Agregar" y sea paciente hasta que se complete el emparejamiento.

Más plataformas de aplicaciones y recomendaciones de pasarelas



SmartThings



Amazon Alexa

Este dispositivo admite las siguientes pasarelas además de SONOFF ZigBee:

Echo Studio
Echo Plus (Modelo: ZE39KL)
2nd Gen Echo Show (Modelo: DW84JL)
2nd Gen Echo Plus (Modelo: L9D29R)
Samsung SmartThings hub

Instrucciones de adición de pasarelas:

1. Consulte el manual del usuario de la pasarela para descargar la aplicación correspondiente y emparejarla.
2. Establezca ZBMINI en el modo de emparejamiento.
3. Agregue ZBMINI de acuerdo con la solicitud de aplicación. Debe seleccionar eWeLink o SONOFF para agregar.

⚠ Si se produce un error al agregar, mueva el subdispositivo más cerca de la puerta de enlace e inténtelo de nuevo.

Especificaciones

Modelo	BASICZBR3
Entrada	100-240V AC 50/60Hz 10A Max
Salida	100-240V AC 50/60Hz 10A Max
ZigBee	IEEE 802.15.4
Sistemas operativos	Android & iOS
Temperatura de funcionamiento	-10°C~40°C
Materiale	PC V0
Dimensiones	91x43x25mm

Introducción al producto

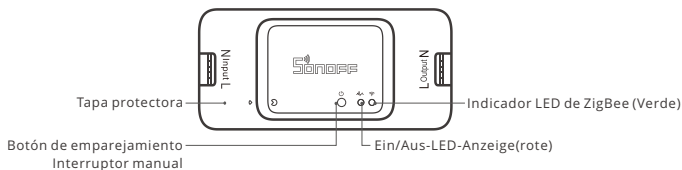

- ⚠ El peso del dispositivo es inferior a 1 kg.
Se recomienda una altura de instalación inferior a 2 m.

Características

El dispositivo inteligente SONOFF ZigBee que utiliza el protocolo de comunicación inalámbrica ZigBee le permite encender/apagar de forma remota, programar dispositivos conectados de encendido/apagado y configurar escenas inteligentes, entre otras funciones.



Control remoto desde plicación



Sincronización simple/regresiva



Control por voz



Escenas



Control compartido

- ⚠ Las funciones de más arriba están determinadas por ZigBee Hub.

Cambiar Red

Si necesitas cambiar la red, presiona sin soltar el botón de emparejamiento por 5 segundos hasta que el indicador de señal LED de ZigBee emitirá parpadeos. y luego de que dispositivo entre en el modo de emparejamiento rápido, podrás emparejarlo de nuevo.

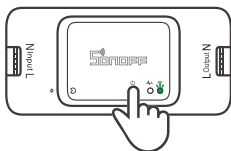

Restablecimiento de los ajustes de fábrica

Si borras el dispositivo en la aplicación eWeLink se restaurará a valores de fábrica.

L'appareil peut être utilisé de manière intelligente en travaillant avec la passerelle SONOFF ZigBee.

ⓘ Le dispositif peut fonctionner avec d'autres passerelles prenant en charge le protocole sans fil ZigBee 3.0. Les informations détaillées sont conformes au produit final.

Instruction d'opération

1. Éteindre

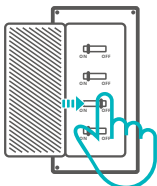

⚠ Pour éviter les électrocutions, prenez contact avec le revendeur ou un professionnel qualifié pour obtenir de l'aide pour l'installation et les réparations éventuelles! Veuillez ne pas toucher l'interrupteur pendant l'utilisation.

2. Instructions de câblage

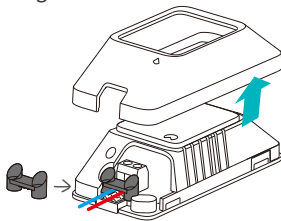

Retirez le capot de protection, puis branchez les fils avant d'installer la fixation de fil.

ⓘ Pour garantir l'installation complète, alignez "▶" sur "●" lorsque vous installez le capot de protection.

Instructions de câblage pour le plafonnier :

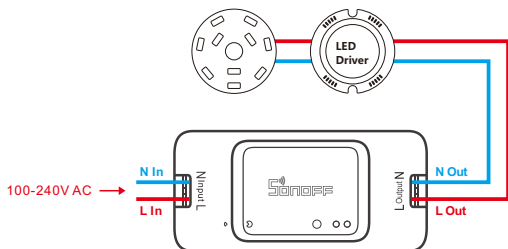

Instructions pour le câblage du fil sous tension :

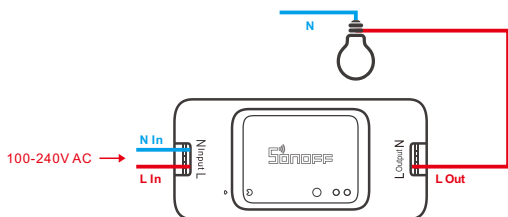

ⓘ Assurez-vous que le fil neutre et le fil sous tension sont correctement installés.

3. Télécharger l'application

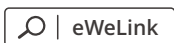

Android™ & iOS

4. Allumer



Après la mise sous tension, l'appareil passe en mode d'appairage lors de la première utilisation et l'indicateur de signal LED ZigBee clignote.

⚠ L'appareil quittera le mode d'appairage si aucune opération suivante n'est effectuée pendant une longue période. Si vous entrez à nouveau, appuyez longuement sur l'interrupteur manuel pendant 5 secondes jusqu'à ce que l'indicateur de signal LED ZigBee clignote et se relâche.

5. Ajouter des sous-appareils

⚠ Connecter la passerelle avant d'ajouter le sous-dispositif.

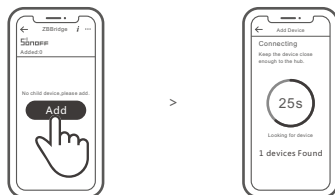

Accédez à eWeLink APP, sélectionnez la passerelle que vous souhaitez connecter et appuyez sur «Ajouter» pour ajouter un sous-dispositif, et soyez patient jusqu'à la fin de l'appairage.

⚠ Si l'ajout a échoué, rapprochez le sous-appareil de la passerelle et essayez à nouveau.

SONOFF ZigBee Passerelle permet de connecter plusieurs sous-appareils en même temps.

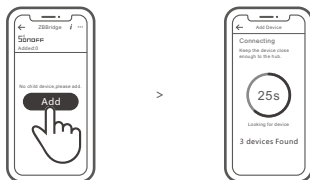

Allumez le Passerelle, mettez le sous-dispositif en mode d'appariement. Accédez ensuite à la page Passerelle dans eWeLink APP pour appuyer sur « Ajouter », et soyez patient jusqu'à ce que l'appariement soit terminé.

Plus de plateformes d'applications APP et de recommandations pour les passerelles



SmartThings



Amazon Alexa

Outre SONOFF ZigBee, ce dispositif prend en charge les passerelles suivantes:

Echo Studio
Echo Plus (model: ZE39KL)
2nd Gen Echo Show (model: DW84JL)
2nd Gen Echo Plus (model: L9D29R)
Samsung SmartThings hub

Passerelle ajoutant des instructions:

1. Consultez le manuel d'utilisation de la passerelle pour télécharger l'APP correspondant et le faire appairer.
2. Réglez ZBMINI sur le mode d'appariement.
3. Ajoutez ZBMINI selon l'invite de l'APP. Vous devez sélectionner eWeLink ou SONOFF lors de l'ajout.

⚠ Si l'ajout a échoué, rapprochez le sous-appareil de la passerelle et essayez à nouveau.

Caractéristiques techniques

Modèle	BASICZBR3
Entrée	100-240V AC 50/60Hz 10A Max
Sortie	100-240V AC 50/60Hz 10A Max
ZigBee	IEEE 802.15.4
Systèmes d'exploitation	Android & iOS
Température de travail	-10°C~40°C
Matériel	PC V0
Dimensions	91x43x25mm

Présentation du produit

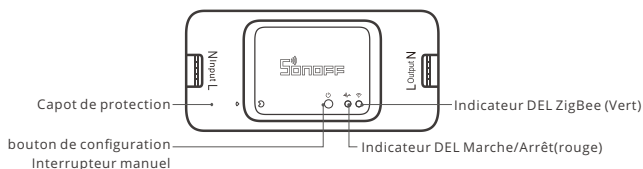

- ⚠ Le poids du dispositif est inférieur à 1 kg.
Il est recommandé d'installer le dispositif à une hauteur inférieure à 2 m.

Caractéristiques

L'Appareil intelligent SONOFF ZigBee sur le protocole de communication sans fil ZigBee vous permet d'allumer/éteindre à distance, de programmer l'allumage/l'extinction des appareils connectés, de définir des scènes intelligentes, etc.



Appli
télécommande



Chronométrage
simple/compte
à rebours



Contrôle vocal



Scènes intelligentes



Contrôle partagé

- ⚠ Les fonctions ci-dessus sont déterminées par ZigBee Hub.

Réseau de commutation

Si vous devez changer de réseau, appuyez longtemps sur le bouton d'appairage pendant 5s jusqu'à ce que le voyant lumineux l'indicateur de signal LED ZigBee clignote. puis relâchez et l'appareil passe en mode de couplage rapide, puis vous pouvez à nouveau vous appairer.

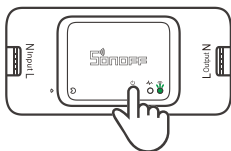

Rétablissement des paramètres d'usine

La suppression de l'appareil sur l'application eWeLink indique que vous le restaurez aux réglages d'usine.

Il dispositivo può essere azionato in modo intelligente attraverso SONOFF ZigBee Gateway.

ⓘ Il dispositivo può essere utilizzato con altri gateway che supportano il protocollo wireless ZigBee 3.0. Le informazioni dettagliate sono conformi al prodotto finale.

Istruzioni per l'uso

1. Spegnimento

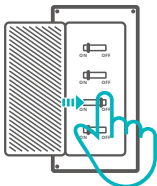

⚠ Per evitare scosse elettriche, consultare il rivenditore o un professionista qualificato per assistenza durante l'installazione e la riparazione! Non toccare l'interruttore durante l'uso.

2. Istruzioni per il cablaggio

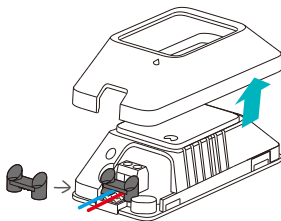

Rimuovere la protezione, quindi collegare i cavi prima di fissare il dispositivo di fissaggio del filo.

ⓘ Per effettuare un'installazione completa, si deve allineare “◆” con “●” quando si fissa la protezione.

Istruzioni per il cablaggio della lampada da soffitto :

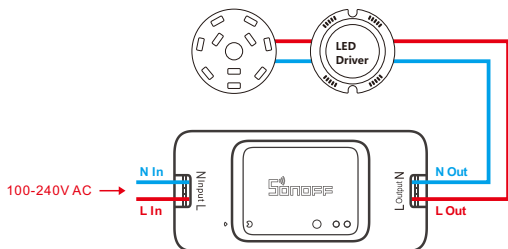

Istruzioni per il cablaggio con un solo cavo di fase:

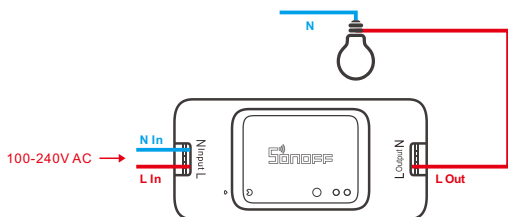

⚠ Assicurarsi che il collegamento del cavo di neutro e del cavo di fase sia corretto.

3. Scarica la APP

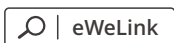

Android™ & iOS

4. Accensione



Al primo utilizzo, dopo l'accensione il dispositivo entrerà in modalità di associazione e l'indicatore LED ZigBee lampeggerà.

- ⚠ Senza nessuna operazione successiva per un lungo periodo di tempo il dispositivo uscirà dalla modalità di associazione. Per entrare di nuovo, tenere premuto l'interruttore manuale per 5s fino a quando l'indicatore di segnale LED ZigBee lampeggia e quindi rilasciare.

5. Aggiungere sotto-dispositivi

- ⚠ Collegare il Gateway prima di aggiungere il sotto-dispositivo.

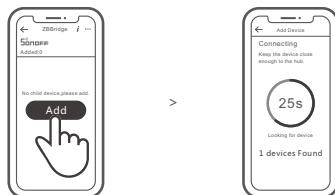

Accedere all'APP eWeLink, selezionare il Gateway che si vuole collegare e toccare "Add" per aggiungere un sotto-dispositivo, Attendere fino al completamento dell'operazione.

- ⚠ Se l'operazione di associazione non dovesse andare a buon fine, avvicinare il sotto-dispositivo al Gateway e riprovare.

SONOFF ZigBee Gateway permette di collegare più sotto-dispositivi contemporaneamente.

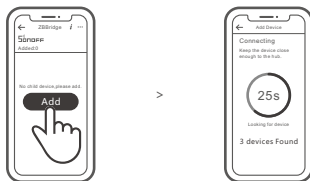

Accendere il Gateway, impostare il sotto-dispositivo sulla modalità di associazione. Quindi accedere alla pagina del Gateway nell'APP eWeLink selezionare "Add", e attendere fino al completamento del processo di associazione.

Ulteriori piattaforme, applicazioni e raccomandazioni per i gateway



SmartThings



Amazon Alexa

Questo dispositivo supporta i seguenti gateway oltre a SONOFF ZigBee:

Echo Studio
Echo Plus (Modello: ZE39KL)
2nd Gen Echo Show (Modello: DW84JL)
2nd Gen Echo Plus (Modello: L9D29R)
Samsung SmartThings hub

Istruzioni aggiuntive per il Gateway:

1. Fare riferimento al manuale utente del gateway per scaricare l'APP corrispondente e associarla.
2. Impostare ZBMINI in modalità abbinamento.
3. Aggiungere ZBMINI in base alle istruzioni dell'APP. Per aggiungere il dispositivo selezionare eWeLink o SONOFF.

⚠ Se l'operazione di associazione non dovesse andare a buon fine, avvicinare il sotto-dispositivo al Gateway e riprovare.

Specifiche

Modello	BASICZBR3
Ingresso	100-240V AC 50/60Hz 10A Max
Uscita	100-240V AC 50/60Hz 10A Max
ZigBee	IEEE 802.15.4
Sistemi operativi	Android & iOS
Temperatura di funzionamento	-10°C~40°C
Materiali	PC V0
Dimensioni	91x43x25mm

Introduzione al prodotto

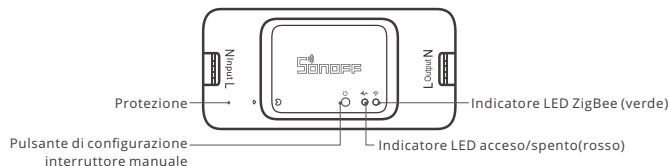

- ⚠ Il peso del dispositivo è inferiore a 1 kg.
Si raccomanda un'altezza di installazione inferiore a 2 m.

Caratteristiche

Il dispositivo intelligente SONOFF ZigBee basato sul protocollo di comunicazione wireless ZigBee consente di accendere/spengere, programmare acceso/spento i dispositivi connessi e impostare scenari intelligenti a distanza, ecc.



Telecomando
via APP



Conteggio singolo/
alla rovescia



Controllo vocale



Scene intelligenti



Controllo della
condivisione

- ⚠ Le funzioni illustrate sopra sono assegnate da ZigBee Hub.

Rete di commutazione

Se è necessario commutare la rete, premere a lungo il pulsante di accoppiamento per 5s fino a quando l'indicatore LED ZigBee lampeggerà. Il dispositivo entra in modalità di accoppiamento rapido ; a questo punto è possibile eseguire di nuovo l'associazione.

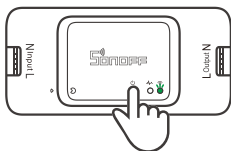

Ripristino impostazioni di fabbrica

La cancellazione del dispositivo sull'applicazione eWeLink indica il ripristino delle impostazioni di fabbrica.

Устройством можно управлять интеллектуально посредством шлюза SONOFF производства компании ZigBee.

⚠ Устройство может работать с другими шлюзами, поддерживающими беспроводной протокол ZigBee 3.0. Подробная информация соответствует характеристикам конечного изделия.

Инструкция по эксплуатации

1. Выключить

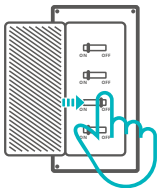

⚠ Во избежание поражения электрическим током при установке и ремонте обращайтесь за консультациями к продавцу или квалифицированному специалисту! Не касайтесь переключателя во время использования.

2. Инструкции по проводке

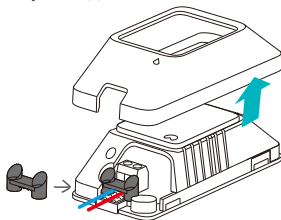

Снимите защиту и подсоедините провода перед тем, как зафиксировать провод крепежом.

⚠ Для завершения установки совместите "♦" с "●" при установке защиты.

Инструкция по проводке: потолочная лампа:

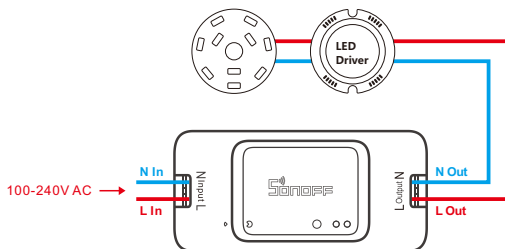

Инструкция по проводке: один провод под напряжением:

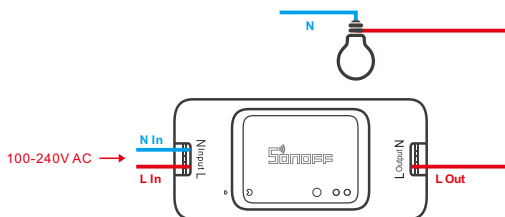

⚠ Убедитесь, что провод нейтрали (ноль) и провод под напряжением (фаза) подключены.

3. Скачать приложение

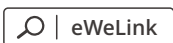

Android™ & iOS

4. Включить

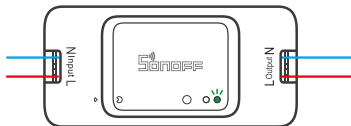

После включения, во время первого использования устройство перейдет в режим сопряжения, и замигают светодиодные сигнальные индикаторы.

- ⚠ Устройство выйдет из режима сопряжения, если на протяжении долгого времени не будет производиться никаких действий. Для повторного подключения зажмите на 5 секунд кнопку включения, после того, как загорятся светодиодные индикаторы, отпустите.

5. Добавьте суб-устройства

- ⚠ Подключите шлюз перед добавлением суб-устройства.

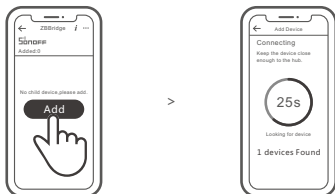

Осуществите доступ к приложению eWeLink, выберите шлюз, который желаете подключить, и коснитесь «Добавить», чтобы добавить суб-устройство, затем ждите завершения процесса установки соединения.

- ⚠ Если добавление не удалось, переместите суб-устройство ближе к шлюзу и повторите попытку.

Шлюз SONOFF ZigBee поддерживает одновременное подключение нескольких суб-устройств.

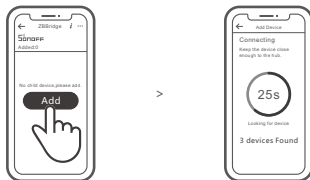

Включите питание шлюза, затем установите субустройство в режим сопряжения. Затем перейдите на страницу шлюза в приложении eWeLink, нажмите «Добавить», и подождите, пока сопряжение не будет завершено.

Больше платформ приложений и рекомендаций по шлюзу



SmartThings



Amazon Alexa

Данное устройство поддерживает следующие шлюзы кроме SONOFF ZigBee:

Echo Studio
Echo Plus (Модель: ZE39KL)
2nd Gen Echo Show (Модель: DW84JL)
2nd Gen Echo Plus (Модель: L9D29R)
Samsung SmartThings hub

Инструкция по добавлению шлюза:

1. Обратитесь к Руководству пользователя шлюза, чтобы скачать соответствующее приложение и выполнить сопряжение.
2. Установите ZBMini в режим сопряжения.
3. Добавьте ZBMini в соответствии с подсказкой приложения. Выберите eWeLink или SONOFF при добавлении.

⚠ Если добавление не удалось, переместите суб-устройство ближе к шлюзу и повторите попытку.

Технические характеристики

Модель	BASICZBR3
входной ток	100-240В пер. 50/60Гц 10А Макс.
выходной ток	100-240В пер. 50/60Гц 10А Макс.
ZigBee	IEEE 802.15.4
Операционные системы	Android & iOS
Рабочая температура	-10°C~40°C
Материалы	PC V0
Размеры	91x43x25 мм

Знакомство с изделием

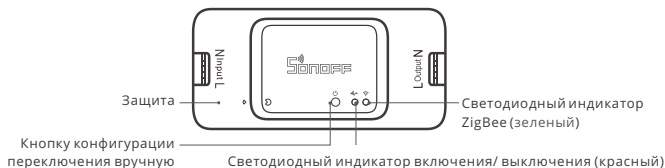

- ⚠ Вес устройства составляет менее 1kg.
Рекомендуется устанавливать устройство на высоте менее 2м.

Функции

Смарт-устройство SONOFF ZigBee, основанное на протоколе беспроводной связи ZigBee, позволит Вам удаленно включать/выключать, планировать включение/выключение подключенных устройств, настраивать смарт-сцены и т. д.



Управ. прилож.



Изолированный таймер/таймер обратного отсчета



Управл. голосом



Смарт-сцены



Доступ д/управл.

- ⚠ Вышеуказанные функции определяются ZigBee Hub.

Переключить сеть

Если Вам необходимо переключить сеть, удерживайте кнопку сопряжения в течение 5 с. и замигают светодиодные индикатор ZigBee сигнальные индикаторы. отпустите. Устройство перейдет в режим быстрого сопряжения, после чего Вы можете снова выполнить сопряжение.

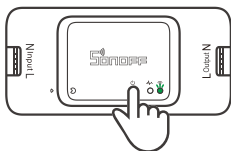

Сброс до заводских настроек

Удаление устройства в приложении eWeLink означает, что Вы восстанавливаете его до заводских настроек.

Устройством можно управлять интеллектуально посредством шлюза SONOFF производства компании ZigBee.

⚠ Устройство может работать с другими шлюзами, поддерживающими беспроводной протокол ZigBee 3.0. Подробная информация соответствует характеристикам конечного изделия.

Instrução de Operação

1. Desligar

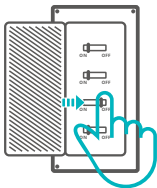

⚠ Para evitar choques elétricos, por favor consulte o seu distribuidor ou um profissional qualificado para auxiliar na instalação e reparo. Por favor não toque no painel durante o uso.

2. Instruções de instalação

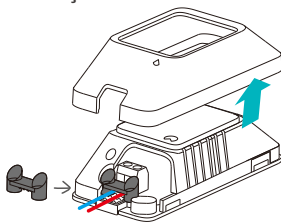

Remova a tampa, então instale os fios antes de fixar o prendedor.

⚠ Para certificar-se de que a instalação está completa, por favor alinhe o "◆" com o "●" ao colocar a tampa novamente.

Instrução para instalação de lâmpada de teto:

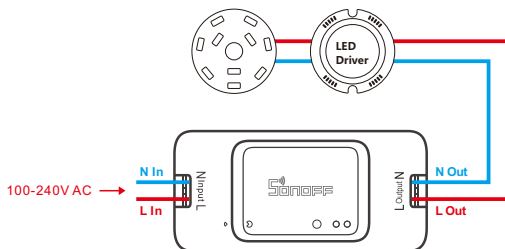

Instruções para instalação de fio único (fase):

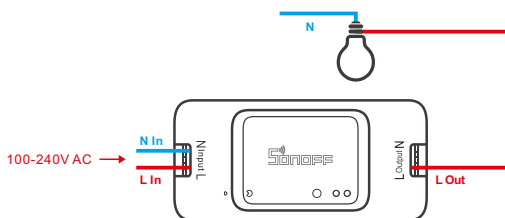

⚠ Certifique-se de que os cabos neutro e fase estejam conectados corretamente.

3. Baixe o APP

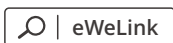

Android™ & iOS

4. Ligue



After powering on, the device will enter the pairing mode during the first use and the LED ZigBee signal indicator flashes.

- ⓘ O dispositivo sairá em modo de pareamento se não houver alguma atividade durante um longo tempo. Se entrar novamente, por favor pressione o botão manual por 5 segundos até o indicador LED ZigBee piscar e solte.

5. Adicionar sub-dispositivos

- ⓘ Conecte o Bridge antes de adicionar o sub-dispositivo.

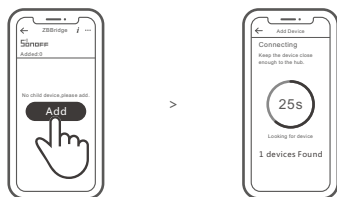

Acesse o aplicativo eWeLink, selecione o Bridge que você deseja conectar e toque em "Adicionar" para adicionar um sub-dispositivo, e seja paciente até que o emparelhamento seja concluído.

- ⓘ Se a adição falhar, mova o sub-dispositivo para mais perto do Bridge e tente novamente.

O SONOFF ZigBee Bridge suporta a conexão de vários sub-dispositivos ao mesmo tempo.

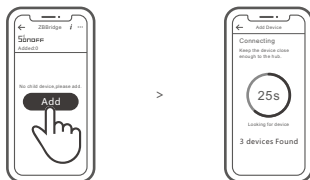

Ligue uma Bridge, defina o sub-dispositivo para o modo de comparação. Em seguida, acesse a página Bridge no eWeLink APP para tocar em "Adicionar" e seja paciente até que o comparador seja concluído.

Mais plataformas e gateways de aplicativos são recomendados.



SmartThings



Amazon Alexa

Este dispositivo suporta os seguintes entregas, além do SONOFF ZigBee Bridge:

Echo Studio
Echo Plus (Modelo : ZE39KL)
2nd Gen Echo Show (Modelo : DW84JL)
2nd Gen Echo Plus (Modelo : L9D29R)
Samsung SmartThings hub

Instruções para adição de entradas:

1. Consulte o manual do usuário para fazer o download do APP correspondente e emparelhamento com a internet.
2. Defina o dispositivo para o modo de emparelhamento.
3. Adicione o dispositivo de acordo com a instrução do APP. Você deve selecionar eWeLink ou SONOFF ao adicionar.

⚠ Se a adição falhar, mova o sub-dispositivo para mais perto do Bridge e tente novamente.

Parâmetros do produto

Modelo	BASICZBR3
Entrada	100-240V AC 50/60Hz 10A Max
Saída	100-240V AC 50/60Hz 10A Max
ZigBee	IEEE 802.15.4
Sistema de operação	Android & iOS
Temperatura de trabalho	-10°C~40°C
Material	PC V0
Dimensão	91x43x25mm

Introdução ao produto

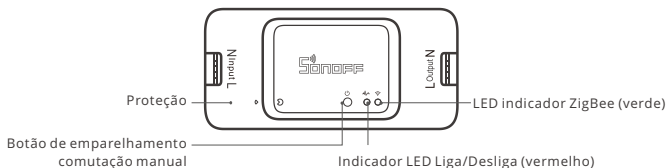

- ⚠ O peso do dispositivo é inferior a 1 kg.
Recomenda-se uma altura de instalação inferior a 2 m.

Funções

Os dispositivos SONOFF ZigBee inteligentes baseados no protocolo de comunicação sem fio ZigBee permitem ligar / desligar remotamente, agendar ligar / desligar dispositivos conectados e definir cenas inteligentes, etc.



Controle pelo aplicativo



Programador de tempo



Controle por voz



Cenas inteligentes



Compartilhar controle

- ⚠ As funções acima são determinadas pela porta de entrada do ZigBee.

Mudar rede

Se você precisar alterar a rede, pressione e segure o botão de emparelhamento por 5s até que o indicador LED ZigBee piscar e solte. então o dispositivo entra no modo de emparelhamento rápido e você pode emparelhar novamente.

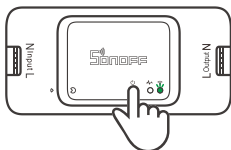

Redefinição de fábrica

Excluir o dispositivo no aplicativo eWeLink indica que você o restaurou para a configuração de fábrica.

FCC Warning

Changes or modifications not expressly approved by the party responsible for compliance could avoid the user's authority to operate the equipment.

This device complies with part 15 of the FCC Rules. Operation is subject to the following two conditions: (1) This device may not cause harmful interference, and (2) this device must accept any interference received, including interference that may cause undesired operation.

FCC Radiation Exposure Statement:

This equipment complies with FCC radiation exposure limits set forth for an uncontrolled environment. This equipment should be installed and operated with minimum distance 20cm between the radiator & your body. This transmitter must not be co-located or operating in conjunction with any other antenna or transmitter.

Note:

This equipment has been tested and found to comply with the limits for a Class B digital device, pursuant to part 15 of the FCC Rules. These limits are designed to provide reasonable protection against harmful interference in a residential installation. This equipment generates, uses and can radiate radio frequency energy and, if not installed and used in accordance with the instructions, may cause harmful interference to radio communications. However, there is no guarantee that interference will not occur in a particular installation. If this equipment does cause harmful interference to radio or television reception, which can be determined by turning the equipment off and on, the user is encouraged to try to correct the interference by one or more of the following measures:

- Reorient or relocate the receiving antenna.
- Increase the separation between the equipment and receiver.
- Connect the equipment into an outlet on a circuit different from that to which the receiver is connected.
- Consult the dealer or an experienced radio/TV technician for help.

Hereby, Shenzhen Sonoff Technologies Co., Ltd. declares that the radio equipment type BASICZBR3 is in compliance with Directive 2014/53/EU. The full text of the EU declaration of conformity is available at the following internet address:

<https://sonoff.tech/usermanuals>

TX Frequency:

2405-2480MHz

RX Frequency:

2405-2480MHz

Output Power:

1.80dBm

The logo features the word "SONOFF" in a bold, black, sans-serif font. Above the letter "O" are three curved lines representing radio signal waves.

Shenzhen Sonoff Technologies Co., Ltd.

1001, BLDG8, Lianhua Industrial Park, shenzhen, GD, China
ZIP code: 518000 Website: sonoff.tech

MADE IN CHINA

